

SPECIFICATIONS:

- White or grey finish
- 1 mirrored door with concealed adjustable hinges
- 2 Interior adjustable shelves
- Satin nickel hardware
- Secure-Mount™ hanging system included
- Fully assembled

OVERALL DIMENSIONS:

23" (W) x 7⁷/₈" (D) x 27⁷/₈" (H)
584.2mm (W) x 200.2mm (D) x 708.2mm (H)

SHIPPING:

Cube 6.30
GW 29.92 lbs



ITEMS TO BE SPECIFIED:

WHITE:

ASWC2328

UPC: 721015372493

GREY:

ASGRC2328

UPC: 721015371816

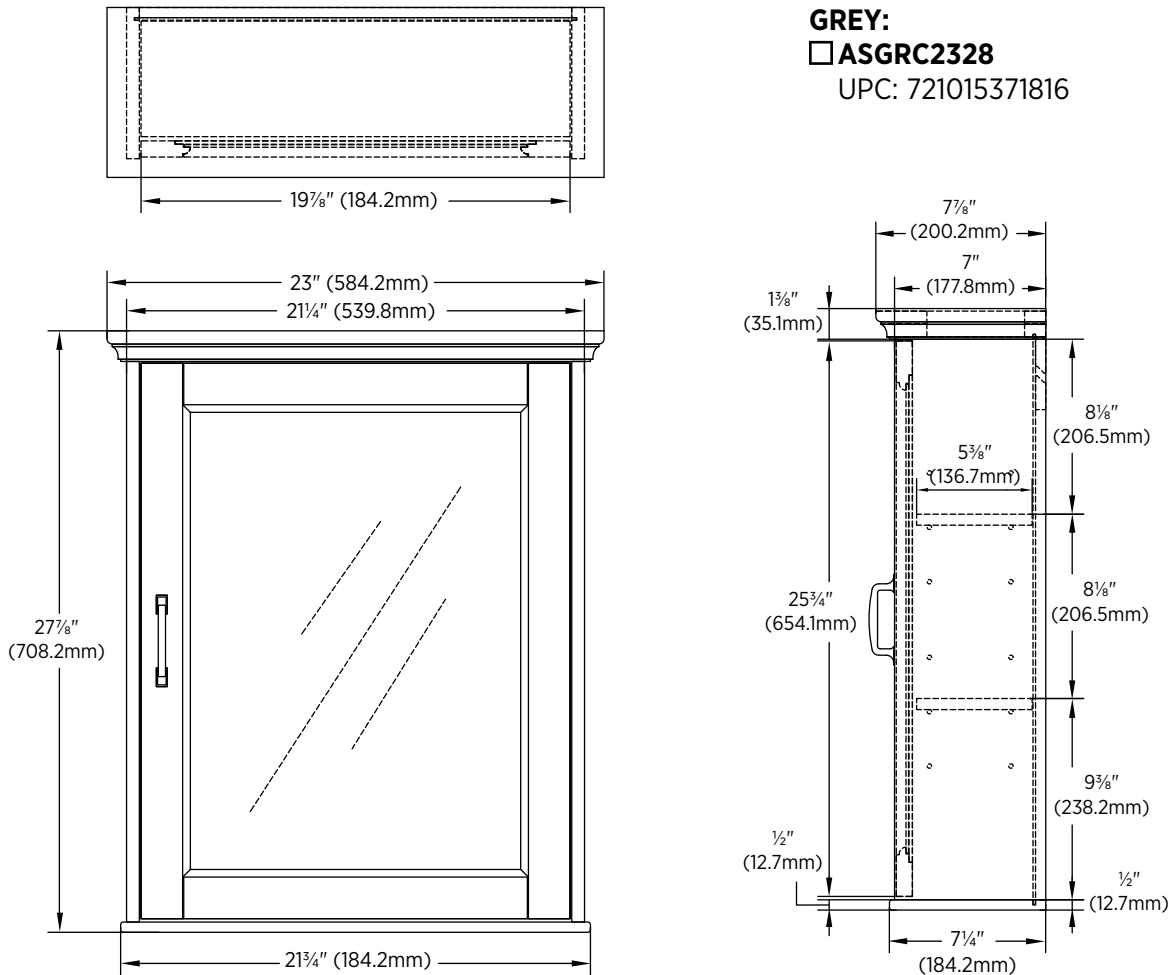

Notes:

Important: Dimensions of product are nominal and may vary within the range of tolerances allowed. These measurements are subject to change or cancellation. No responsibility is assumed for use of superseded or voided pages.