

FOREMOST®

OPERATING MANUAL/INSTALLATION STEPS



STEP-BY-STEP ILLUSTRATED

Massa Intelligent Bidet Seat

PRODUCT DIAGRAM

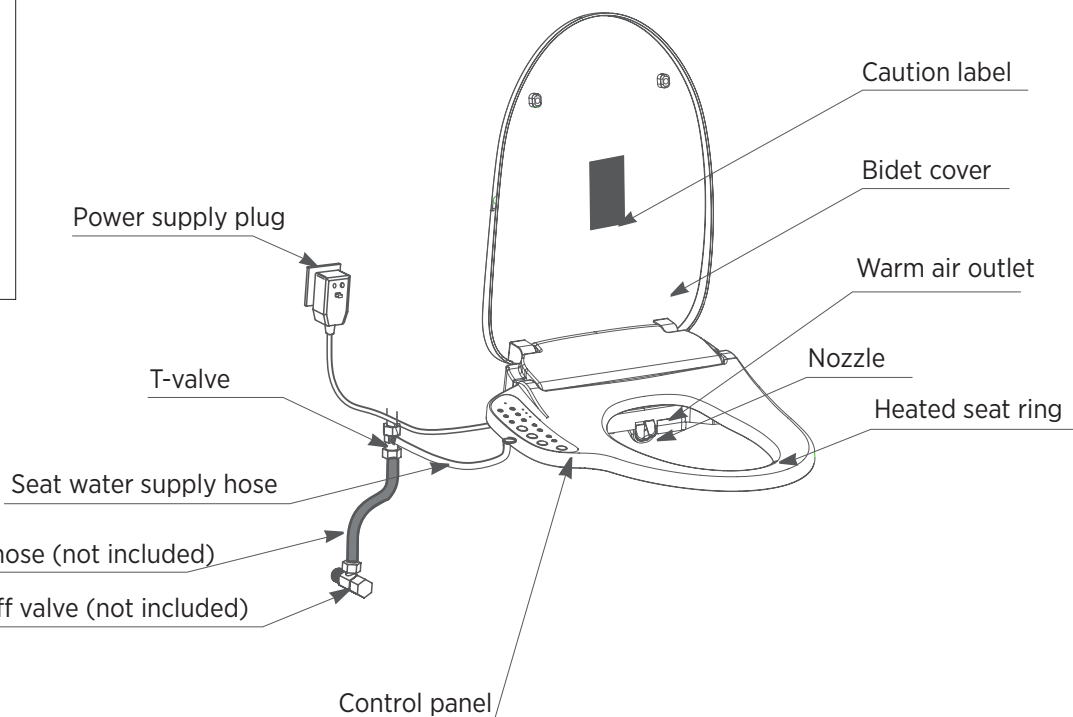
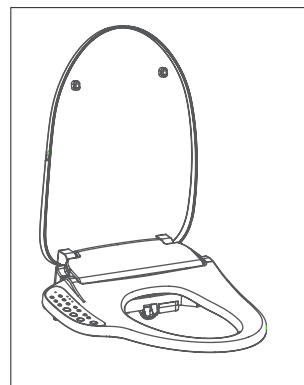

VIEW FROM RIGHT AND LEFT SIDE OF MASSA INTELLIGENT BIDET SEAT

Right hand view

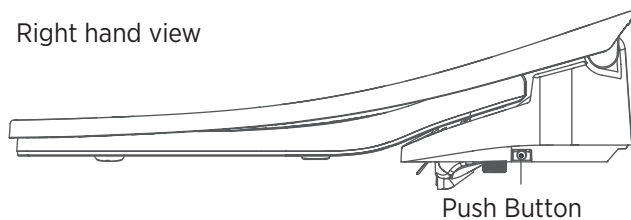

Push Button

Left hand view

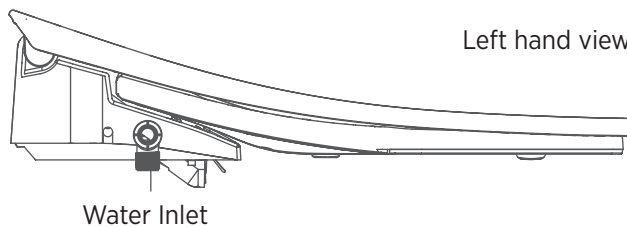

Water Inlet

- Prior to installation and use, please read this operating manual carefully.
- Please keep this manual after installation for quick reference in future needs.

FOREMOST®

OPERATING MANUAL/INSTALLATION STEPS



STEP-BY-STEP ILLUSTRATED

Massa Intelligent Bidet Seat



WARNING

If not followed, may result in serious injury.



Grounding

This product must be grounded before use and plugged into an (AC 110V, 60Hz) power outlet.
*Failing to do so can cause fire or electric shock.



Prohibited

Do not use a damaged power cord, plug or loose electric outlet.
*Doing so may cause fire or electric shock.



Wet hands prohibited

Do not plug or unplug the power plug with wet hands.
*Doing so may cause electric shock.



Feu interdit

Keep cigarettes and other open flames away from the product.
*Doing so may cause fire, electric shock, heat or short circuit.



Disassembling or repair prohibited

Never disassemble, repair or alter the product.
*Doing so may cause fire, electric shock, heat or short circuit.



Prohibited

Children, elderly, patients and those who are physically limited should be accompanied during use of toilet at all times.
*Seated for long periods of time may cause low temperature burn.



CAUTION

May result in electric shock, fire, injury, and property damage.



Prohibited

Do not strike, pull, twist, excessively bend, damage, alter, or heat the power cord.



Prohibited

Do not slam or close the seat cover forcefully.



Prohibited

Do not stand on the top of the seat cover, seat or main body unit. This can damage or break the unit.



Prohibited

When cleaning or not using the product over a long period of time, be sure to unplug the unit.



Prohibited

Prevent children from throwing substances or inserting their hands into the dryer outlet or into the nozzle.



Prohibited

Never submerge the product into water.

FOREMOST®

OPERATING MANUAL/INSTALLATION STEPS



STEP-BY-STEP ILLUSTRATED

Massa Intelligent Bidet Seat

IMPORTANT SAFEGUARDS

When using electrical products, especially when children are present, basic safety precautions should always be followed, including the following:

READ ALL INSTRUCTIONS BEFORE USING

A. DANGER– To reduce the risk of electrocution:

1. Do not use while bathing.
2. Do not place or store product where it can fall or be pulled into a tub or sink.
3. Do not pour or spray water or other liquid onto the product.
4. Do not touch the toilet seat if it has fallen into the water. Unplug the toilet seat immediately or turn off electricity at the breaker box.
5. Never operate this product if it has a damaged cord or plug, if it is not working properly, if it has been dropped or damaged, or dropped into water.

B. WARNING– To reduce the risk of burns, electrocution, fire, or injury to persons.

1. Close supervision is necessary when this product is used by children or people with physical disabilities.
2. Use this product only for its intended use as described in this manual. Do not use attachments not recommended by the manufacturer.
3. Keep the power supply cord away from heated surfaces.
4. Never block the air openings of the product. Keep the air openings free of lint, and dust.
5. Never use while sleeping or drowsy.
6. Never drop or insert any object into any opening or hose.
7. Do not use outdoors.
8. Do not operate where aerosol (spray) products are being used or where oxygen is being administered.
9. Connect this product to a properly grounded outlet only.

SAVE THESE INSTRUCTIONS

- Return the product to place of purchase for examination and repair.

FOREMOST®

OPERATING MANUAL/INSTALLATION STEPS



STEP-BY-STEP ILLUSTRATED

Massa Intelligent Bidet Seat

GROUNDING INSTRUCTIONS

Important: It is incumbent upon the installer/homeowner to consult local building and electrical codes to insure proper installation of this toilet seat.

The Massa Intelligent Bidet Seat is manufactured with a Ground Fault Circuit Interrupter (GFCI) plug. The GFCI provides a safety mechanism and a grounding wire to guard against an electrical shock.

Should this toilet seat come into contact with water or incur any surge in electrical current the GFCI plug would stop the electrical current from continuing past the GFCI plug. This safety shut off ensures there is no personal or property damage.

Resetting

In the event of an electrical surge the GFCI will engage the shut off switch. To reset the GFCI simply press down the reset button on the plug. This will return the GFCI plug to its original operating setting.

Warning Note

Should this GFCI become damaged for any reason please consult a Licensed Electrician for repair or replacement. DO NOT ATTEMPT THIS YOURSELF.

Check with a licensed electrician or serviceman if the grounding instructions are not completely understood. Or if there is any doubt the product is properly grounded.

This product is for use on a nominal 110V circuit, and has a GFCI that looks like the electrical plug illustrated below.

This product has been certified by



GROUNDING METHODS

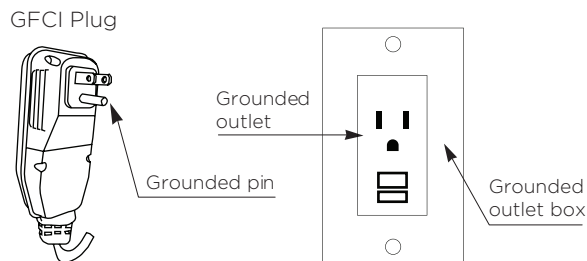

FOREMOST®

OPERATING MANUAL/INSTALLATION STEPS



STEP-BY-STEP ILLUSTRATED

Massa Intelligent Bidet Seat

HARDWARES AND PARTS LIST

QTY

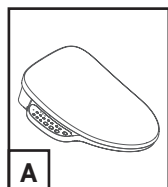

A

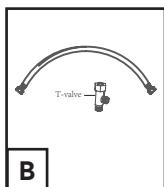

B

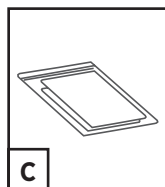

C

A Massa Intelligent Bidet Seat Cover

x1

B Seat water supply hose & T-valve

x1 Set

C Operating manuals and other printed material

x1

D Mounting plate

x1

E Seat bolts kit

x2

F Template

x1

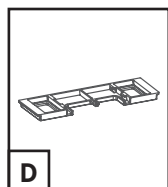

D

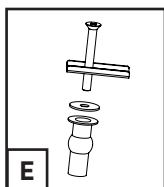

E

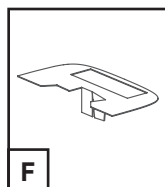

F

• Please confirm that all articles in the package are complete. If any of parts are missing, please contact our customer service department at **1-888-256-7551 Canada or 1-888-620-3667 USA**

NOTES FOR INSTALLATION

Water Requirements

- The minimum dynamic water pressure required is 11.6 psi (0.8 kg / square cm).
- The maximum static water pressure required is 101.5 psi (7 kg / square cm).
- Water pressure below the minimum and maximum range above will affect the performance of the product.

Minimum Water Pressure Confirmation Essentials

This method can be used if you have no water measuring gauge:

Open the water supply angle valve

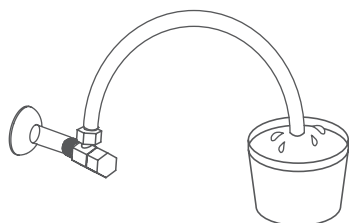

Measure whether the amount of water flowing out within 10 seconds reaches 3 litres/0.8 gallons, and if it reaches 3 liters/0.8 gallons, it indicates that the installation requirements are met. Otherwise, the booster device needs to be installed for pressurization.

FOREMOST®

OPERATING MANUAL/INSTALLATION STEPS



STEP-BY-STEP ILLUSTRATED

Massa Intelligent Bidet Seat

INSTALLATION STEPS

1

REMOVE EXISTING SEAT (FIGURE 1)

FIGURE 1

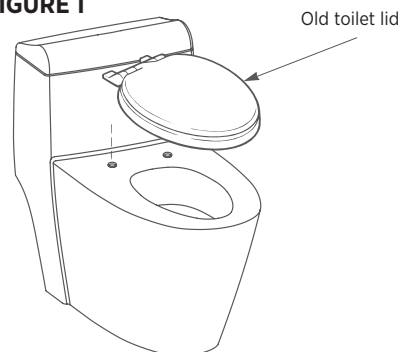

2

INSERT THE RUBBER PLUG

Insert the rubber plug into each of the bowl holes (**FIGURE 2**).

FIGURE 2

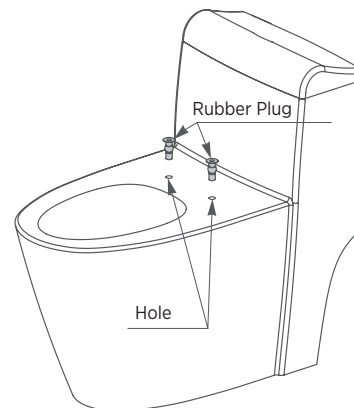

3

PLACE TEMPLATE

Place the template horizontally on the ceramic surface. Fold the edgefold vertically downward against the rear rim of bowl (**FIGURE 3**).

FIGURE 3

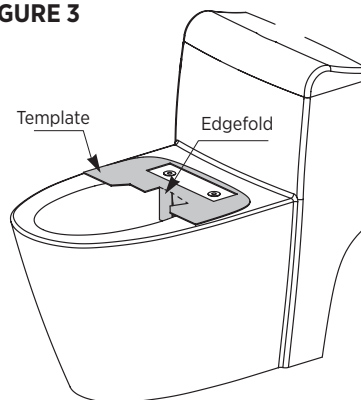

FOREMOST®

OPERATING MANUAL/INSTALLATION STEPS



STEP-BY-STEP ILLUSTRATED

Massa Intelligent Bidet Seat

INSTALLATION STEPS

4

ATTACHING THE MOUNTING PLATE

Attaching the mounting plate. Place the mounting plate on the blank space and use the screwdriver to tighten the bolt with bolt guide from top **(FIGURE 4)**.

Note: ↑ mark on the mounting plate shall point toward back of toilet.

FIGURE 4

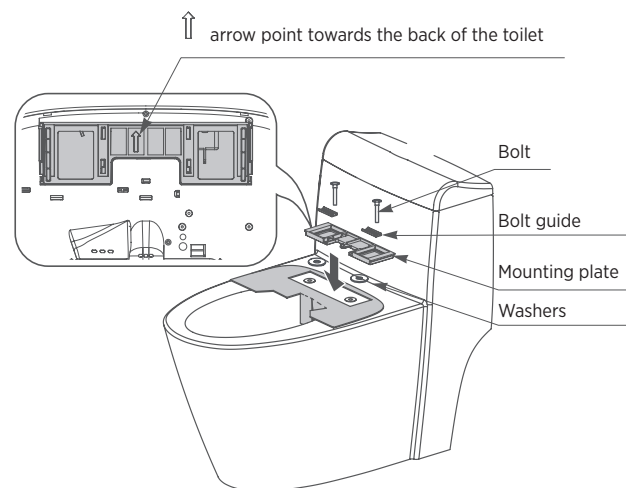

5

ATTACH THE TOILET SEAT

Attach the toilet seat. Remove the template and press the push button and slide the seat horizontally into the mounting plate until the click sound is heard **(FIGURE 5)**.

To detach seat: Press button and lift unit up and forward.

FIGURE 5

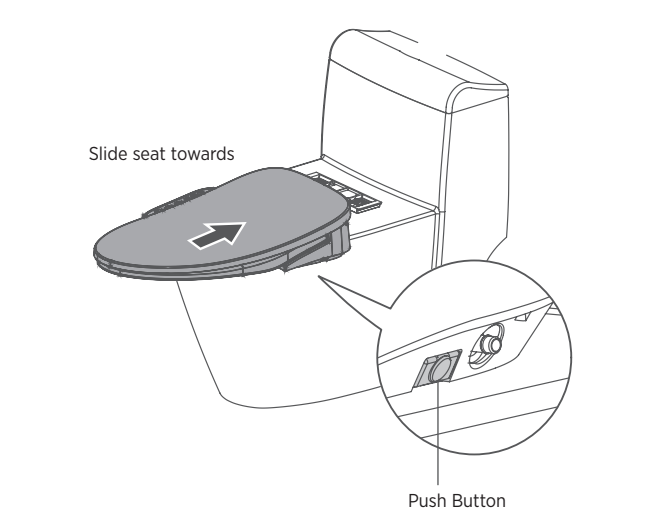

For full instructions please visit our website www.foremostcanada.com / www.foremostbath.com OR Scan QR Code.



FOREMOST®

OPERATING MANUAL/INSTALLATION STEPS



STEP-BY-STEP ILLUSTRATED

Massa Intelligent Bidet Seat

INSTALLATION STEPS

6

WATER SUPPLY

Shut off the water at the water supply shut off valve and disassemble the existing water supply hose from the bottom of toilet tank (**FIGURE 6**).

FIGURE 6

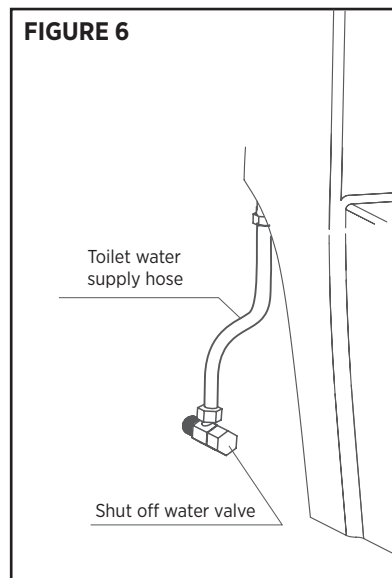

7

CONNECTING THE T-VALVE

Connect the T-valve to the toilet water tank (fill valve shank) then connect the seat water supply hose to the T-valve and to the filter inlet on the smart toilet seat (**FIGURE 7**).

Finally connect toilet water supply hose (not included) to T-valve and water shut off valve.

Turn on the water shut off valve and if leakage is found.

FIGURE 7

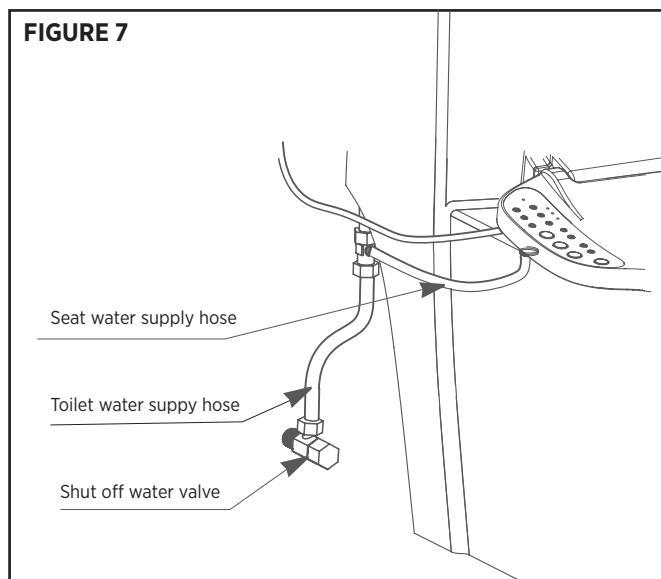

8

PLUG THE GFCI POWER PLUG

Plug the GFCI power plug to the wall grounded outlet and start to enjoy the Smart Toilet Seat.

FOREMOST®

OPERATING MANUAL/INSTALLATION STEPS



STEP-BY-STEP ILLUSTRATED

Massa Intelligent Bidet Seat

OPERATION & FUNCTIONS

The Smart toilet seat automatically turns on when it senses body weight being applied to the seat ring. The wash functions and warm air function will not work unless the body sensor on the seat ring detects body weight.

POSTERIOR



- The water is sprayed from the nozzle to wash the posterior area.
- Pressing the button again will change the mode into oscillating cleaning and expand the spray range.

FEMININE



- The water is sprayed from the nozzle to wash the feminine area.
- Pressing the button again will change the mode into oscillating cleaning and expand the spray range.

UV STERILIZATION



- The UV sterilizing lamp cannot be controlled.
- Automatically runs 20 seconds after the cleaning, and turns off after 3 minutes or when the cleaning function is used again.

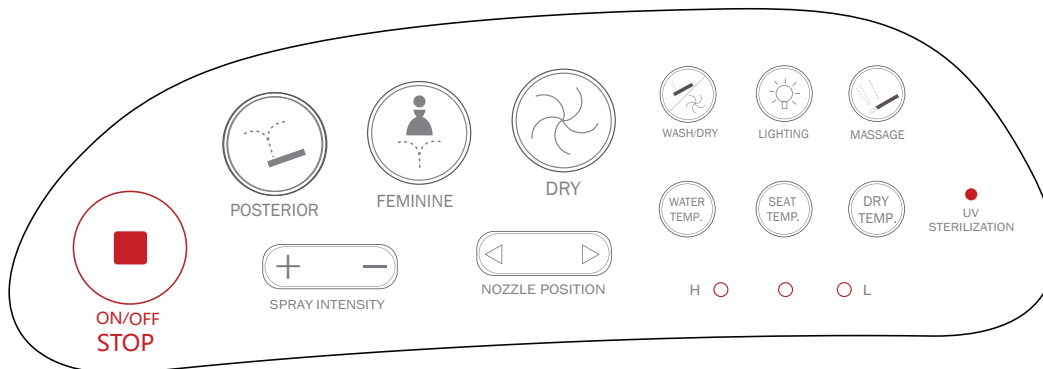

ON/OFF STOP



- Stops all washing and drying function currently running.

SPRAY INTENSITY



- Adjusts water pressure.
- To Activate: Press "+" or "-" to increase or decrease water pressure.

NOZZLE POSITION



- *Nozzle position can move back and forth by 5 gears.

FOREMOST®

OPERATING MANUAL/INSTALLATION STEPS



STEP-BY-STEP ILLUSTRATED

Massa Intelligent Bidet Seat

OPERATION & FUNCTIONS

WASH/DRY



- Press to start the posterior wash for 90 seconds, then dry for 4 minutes.
- If pressed again during 90 seconds, it will skip to drying function.

MASSAGE



- While washing, press the button to start the cycle of cold and warm water.
- Only available when the "POSTERIOR" or "FEMININE" wash function has started.
- Press again to stop the massage.

DRY



- Press to dry the front and rear areas.
- Switch the display of [LOW], [MED], [HIGH], [OFF].
- Stops automatically after 4 minutes.

LIGHTING



- Turn the night light on/off.

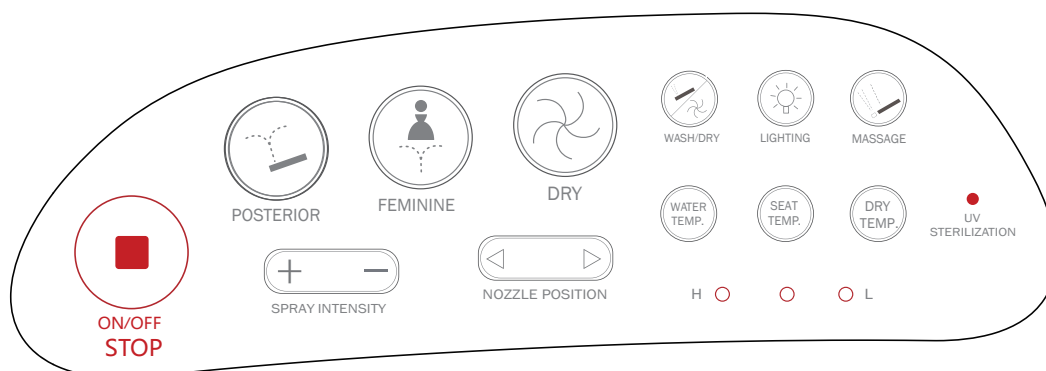

WATER TEMP.



- Shows the current temperature when pressed once.
- Press again to change the temperature.
- Default temperature is MEDIUM.
- Switch the display to [LOW], [MED], [HIGH], [OFF].

SEAT TEMP.



- Shows the current temperature when pressed once.
- Press again to change the temperature.
- Default temperature is MEDIUM.
- Switch the display to [LOW], [MED], [HIGH], [OFF].

DRY TEMP.



- Shows the current temperature when pressed once.
- Press again to change the temperature.
- Default temperature is MEDIUM.
- Switch the display to [LOW], [MED], [HIGH], [OFF].

To restore to factory settings:

- If there is a confusion (higher water temperature, lower seat temperature, weaker spray strength) while using, please unplug the seat for 1 minute, then reconnect it. The water temperature, seat temperature, drying temp. and spray strength, nozzle position will restore to middle level settings.

FOREMOST®

OPERATING MANUAL/INSTALLATION STEPS



STEP-BY-STEP ILLUSTRATED

Massa Intelligent Bidet Seat

MAINTENANCE

Daily cleaning precautions

Please do not spray water into the product.

When cleaning the toilet bowl keep the seat open after cleaning.

Clean it carefully, do not leave the cleaning agent in the gap between the cover and the ceramic.

The sensor area should be kept clean. Failure to do so may affect the sensor functions.

1

CLEANING STEPS

Unplug the power (**FIGURE 8**).

FIGURE 8

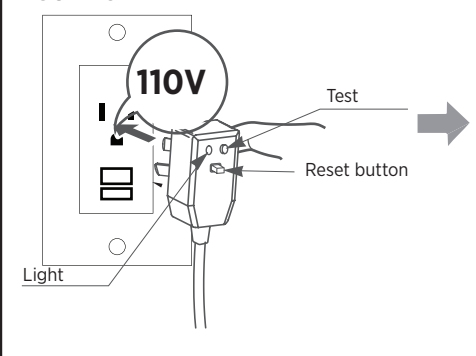

2

CLEANING THE BODY

Cleaning the body: Regularly wipe the seat with a dry cloth or sponge, or wash with a damp cloth and mild detergent (**FIGURE 9**).

Note: In order to protect the unit, only use mild, non abrasive cleansers.

FIGURE 9

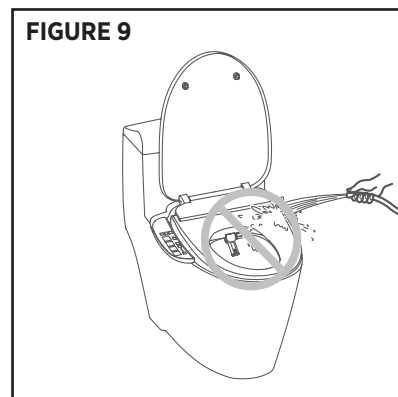

FOREMOST®

OPERATING MANUAL/INSTALLATION STEPS



STEP-BY-STEP ILLUSTRATED

Massa Intelligent Bidet Seat

3

MAINTENANCE OF THE STEEL MASH FILTER

Turn the coin counterclockwise to open the filter and clean with a brush **(FIGURE 10)**.

FIGURE 10

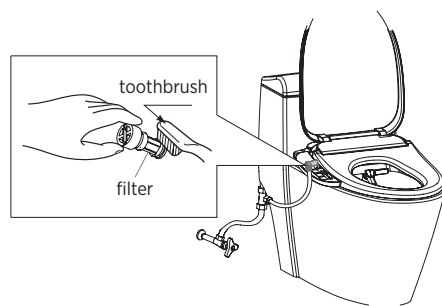

4

MAINTENANCE OF THE NOZZLE

In the non-working state, hold "water temperature" for 3 seconds to open the nozzle cleaning mode, you can use a soft brush for cleaning.

Press the "stop" button to end this function.

Do not try to pull the nozzle out forcefully, or the nozzle may break **(FIGURE 11)**.

FIGURE 11

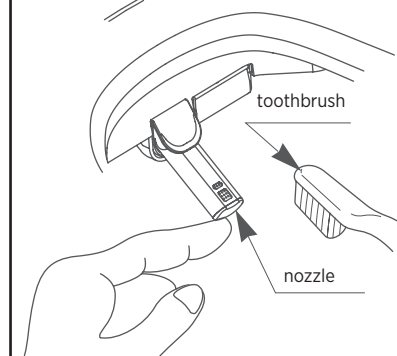

FOREMOST®

1 YEAR LIMITED WARRANTY

All Foremost® products are carefully tested prior to shipping. Foremost® warrants this product to be free from defects in material and workmanship for a period of 1 year from the original purchase date. Please keep all sales receipts for proof of purchase.

This Warranty excludes the following:

1. Replacement of discolored or damaged parts as a result of strong cleaning or disinfecting chemicals.
2. Damage to, or malfunction of the unit resulting from improper installation, negligence, misuse, abuse or tampering by an unauthorized repair personnel.
3. Under no circumstances will Foremost be held liable for any loss or damage directly, consequentially or incidentally arising out of the use of, or inability to use this product.
4. The owner of the Smart Toilet Seat should immediately stop using when the water leakage found.

Leakage can be the result of incompatible toilet fitting, improper installation, and/or old or damaged parts.

5. Exposure to extreme temperatures, strong chemicals (such as bleach, hydrochloric acid, etc.) or high water pressure can cause damage to various parts of the bidet function and result in leaking and flooding. Therefore, the owner hereby releases the Manufacturer and Distributors of Smart Toilet Seat cover from any and all claims for bodily and/or properly damage resulting from such conditions.

6. Damage or loss resulting from electrical surges, electrical outages, lightning strikes or other acts are not covered by this warranty.

7. The owner hereby releases Foremost® from any or all claims against damages to the property or the Smart Toilet Seat resulting from misuse, improper installation, inadequate maintenance, or exposure to extreme temperature, water pressure or strong chemicals.

**To obtain warranty service or product information call Customer Relations Department
Warranty Service Group 1-888-256-7551 (CANADA) or 1-888-620-3667 (USA)**

Model Number	BTS-1005E-W	Range of water intake pressure for use	Min. necessary water pressure	11.6psi (over 3.95gal/min when water is running)
Voltage / Frequency	110V, 60Hz		Max. water pressure	101.5psi (in motionless state)
Rated Power Consumption	1140W			
Plug	GFCI Plug	Length of Power Cord		About 1.16m (3.8 ft) (including plug)
Temperature	Water	Adjustable (4 Levels) 104°F (Max.)	Dimension of the product	
	Air	Adjustable (4 Levels) 131°F (Max.)		
	Seat	Adjustable (4 Levels) 104°F (Max.)		

Visit our website for video tutorials, product knowledge and troubleshooting:
www.foremostcanada.com/videos

New videos added regularly

TROUBLESHOOTING

Try these trouble shooting solutions if you run into issues, or please contact our Customer Service Department.

Type	Problem	Factors to check
Toilet is not working	Blackout or loose socket	Check the power cord is plugged in
	Electric leakage	Unplug power cord, re-connect, then power on. If it is still not working, please unplug again and contact us.
Water does no spray	No water in the supply	Wait for the water to restore to its normal level
	Water supply is turned off	Turn on the water supply valve
	Water hose is twisted	Stretch hose until it becomes untwisted
Water pressure is weak	Water level is set to LOW	Turn up the water level to a higher setting
Spray is off-center	Operational failure	Unplug device and re-plug in after 1 minute.
Water is not warm	Water temp. is set to LOW	Turn up the water level to higher setting
Water is leaking	Parts are loose or damaged	Contact us
Wash function does not activate	The body sensor can't detect your sitting down.	Adjust your sitting position so that the body sensor can be fully activated.
	Body sensor is broken	Contact us
Dryer is not warm	Dryer temp. is set to OFF	Turn up the dryer temperature to a higher setting
	Dryer is broken	Contact us
Dryer stops during use	Dryer will stop for every 4 minute	Enable dryer again
Seat temp. not warm	Seat temp. is set to OFF	Turn up the seat temperature to a higher setting
	Power-saving mode on	Turn off power-saving mode
Lid or seat closes fast	Damper is damaged	Contact us
Functions cycles nonstop	QA testing model activated	Unplug device and re-plug in after 1 minute to reset the functions

FUNCTIONS OF PRODUCTS

Category	Function	BTS-1005E-W
Cleaning	Rear cleansing	●
	Front cleaning	●
	Mobile cleaning	●
	One Touch cleaning (Wash/Dry)	●
	Self-cleaning of nozzle	●
	Warm and cold massage cleaning	●
	Water temperature regulating	●
	Water pressure regulating	●
Comfort	Warm air drying	●
	Seat heating	●
	Slow close	●
	Nozzle position adjustment	●
Convenience	Variable frequency instant heating	●
	Intelligent body sensor	●
	Power saving function	●
	Operating mode	Side control panel operation
	Soft light at night	●
	Self diagnosis	●
Safety and environment protection	Antibacterial seat	●
	Antibacterial nozzle	●
	Eight-fold security protection	●
	Medical ultraviolet sterilization	●
	Prevent sewage from pouring back	●

Remarks: ● signifies that the product has this function.

Please read this product manual carefully before installation and use. Save these instructions.

FOREMOST INTERNATIONAL LTD. (CANADA):
5970 Chedworth Way, Unit B, Mississauga,
Ontario, Canada L5R 4G5 - 1-888-256-7551
www.foremostcanada.com

FOREMOST GROUPS INC. (U.S.A.): 6241
Northwind Parkway, Hobart, IN, USA 46342 -
1-888-620-3667 www.foremostbath.com